

LEGACY PARK

MASTER PLAN

MS-302/Goodman Rd at Polk Lane | Olive Branch, MS

4.2M Square Feet

Class A Industrial

Legacy Park is a Class A logistics park located on 266 acres in DeSoto County. This eight building project sits along the frontage of State Highway 302/Goodman Road providing direct highway access and direct access to Polk Lane.



LEGACY PARK | MASTER PLAN

MS-302/GOODMAN RD AT POLK LANE | OLIVE BRANCH, MS

PROPERTY OVERVIEW

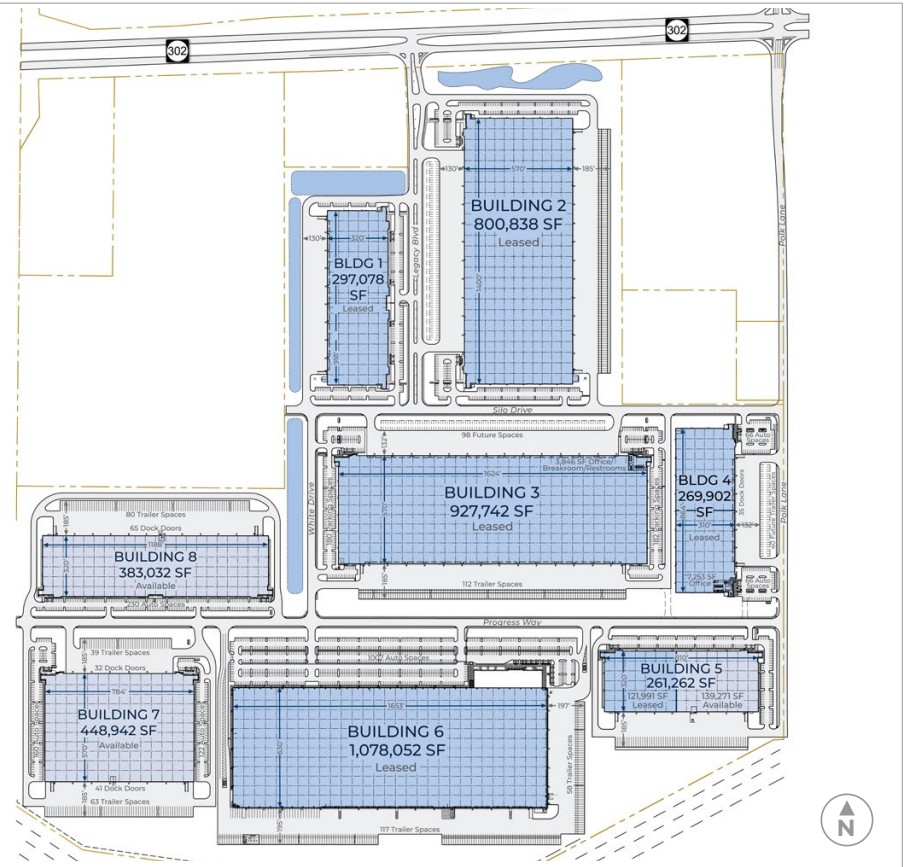

139,271 SF to 448,942 SF



TPO roof



Single and cross-dock loading



32' – 36' clear heights



LED lighting



185' – 197' truck courts



ESFR sprinkler system

Development



TODD BLANTON

901 682 4694 (o) | 205 229 3457 (c)
todd.blanton@hillwood.com

Leasing



ANDY CATES

901 312 4907 (o) | 901 301 0829 (c)
andy.cates@colliers.com

TIM MASHBURN

901 312 5771 (o) | 901 356 2900 (c)
tim.mashburn@colliers.com

LEGACY PARK | MASTER PLAN

MS-302/GOODMAN RD AT POLK LANE | OLIVE BRANCH, MS

AREA INFORMATION



BUSINESSES



1. FedEx World Hub
2. UPS Sort Hub
3. FedEx Ground Hub

DRIVE TIMES



BNSF Intermodal

 9 mi.  18 min.



Memphis International Airport

 17 mi.  30 min.

Norfolk Southern Intermodal

 15 mi.  20 min.

Memphis CBD

 28 mi.  42 min.

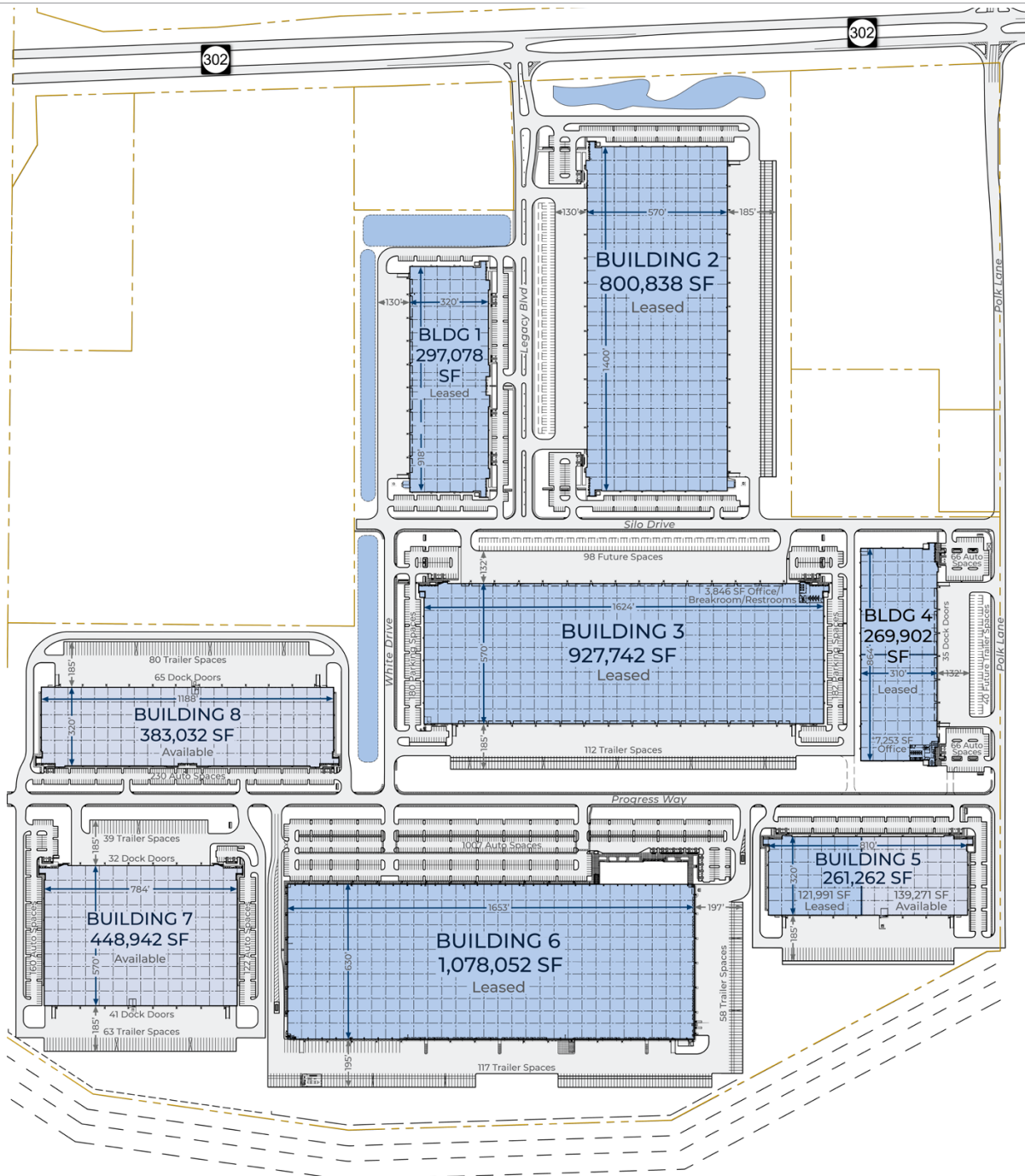

LEGACY PARK | MASTER PLAN

MS-302/GOODMAN RD AT POLK LANE | OLIVE BRANCH, MS

PROPERTY PHOTOS



CONTACT

DEVELOPMENT



TODD BLANTON

901 682 4694 (o) 6410 Poplar Ave | Ste 385
205 229 3457 (c) Memphis, TN 38119
todd.blanton@hillwood.com hillwood.com

LEASING



ANDY CATES

901 312 4907 (o) 6363 Poplar Ave | Ste 220
901 301 0829 (c) Memphis, TN 38119
andy.cates@colliers.com colliers.com



This information has been obtained from sources believed reliable, but has not been verified for accuracy or completeness. You should conduct a careful, independent investigation of the property and verify all information. Any reliance on this information is solely at your own risk. Hillwood and the Hillwood logo are service marks of Hillwood. All other marks displayed on this document are the property of their respective owners, and the use of such logos does not imply any affiliation with or endorsement of Hillwood. Photos herein are the property of their respective owners. Use of these images without the express written consent of the owner is prohibited.