



CENTRA⁵L PARK

**LOGISTICS CENTER
IM RÖDLING | CARL-ZEISS-STRASSE | WEITERSTADT
FOR RENT APPROX. 5,000 TO 34,000 SQ. M
EXCLUSIVE MANDATE - FREE OF COMMISSION**

CBRE | INDUSTRIAL & LOGISTICS | GERMANY



CENTRA⁵L PARK
IM RÖDLING | CARL-ZEISS-STRASSE | 64331 WEITERSTADT

A NEW CLASS-A LOGISTICS DEVELOPMENT IDEALLY SITUATED IN THE CENTRAL RHINE-MAIN REGION. PRIME LOGISTICS HUB AREA ONLY ONE KM FROM THE A5 MOTORWAY. EASY ACCESS TO ALL MAJOR NORTH-SOUTH AND EAST-WEST CONNECTIONS ALLOWS FOR EFFICIENT OPERATIONS AND TIMELY DISTRIBUTION. FLEXIBLE WAREHOUSE CONFIGURATION, BUILT TO HIGH SPECIFICATIONS. THAT'S... CENTRA⁵L PARK!

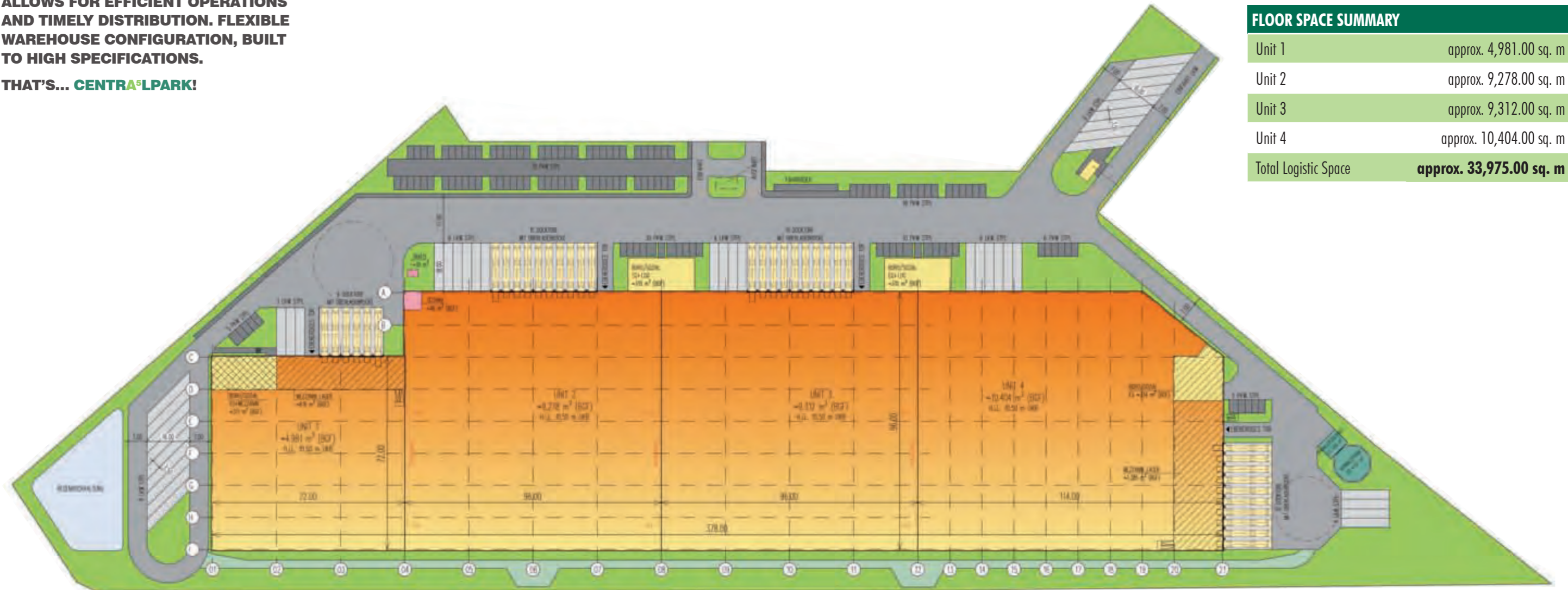

CENTRA⁵L PARK

CENTRA⁵L PARK

IM RÖDLING | CARL-ZEISS-STRASSE | 64331 WEITERSTADT

LOCATION

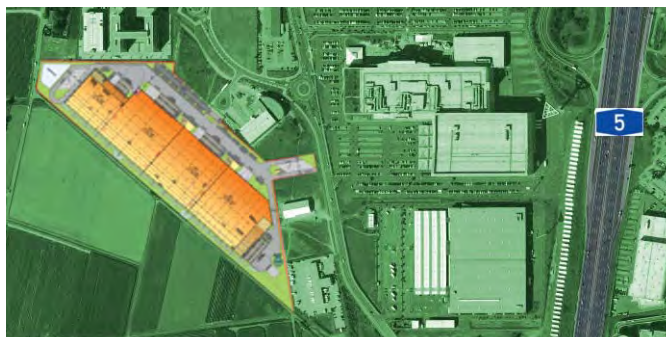

KEY FACTS

KEY DATA	
Site	approx. 71,158 sq. m
Warehouse	approx. 33,975 sq. m
Office	approx. 2,196 sq. m
Mezzanine	approx. 2,001 sq. m
Accessibility	- 36 loading docks - 1 level access door
Clear Height	10,50 m
Floor load capacity	5 t/sq. m
Estimated completion	Q1 2016
Distances to major cities	- Frankfurt am Main, approx 18 km (Airport Cargo City Süd) - Wiesbaden, approx 38 km

Disclaimer 2015 CBRE

Information herein has been obtained from sources believed reliable. While we do not doubt its accuracy, we have not verified it and make no guarantee, warranty or representation about it. It is your responsibility to independently confirm its accuracy and completeness. Any projections, opinions, assumptions or estimates used are for example only and do not represent the current or future performance of the market. This information is designed exclusively for use by CBRE GmbH clients, and cannot be reproduced without prior written permission of CBRE GmbH.

YOUR EXCLUSIVE AGENT CONTACTS

CBRE

cbre.de



Armin Herrenscheider
Senior Director
Head of Industrial & Logistics Germany

CBRE GmbH
Bockenheimer Landstraße 24
60323 Frankfurt am Main
T: +49 (0)69 / 17 00 77 43
F: +49 (0)69 / 17 00 77 79
armin.herrenscheider@cbre.com



Florian Stöbe
Senior Consultant
Industrial & Logistics Frankfurt

CBRE GmbH
Bockenheimer Landstraße 24
60323 Frankfurt am Main
T: +49 (0)69 / 17 00 77 605
F: +49 (0)69 / 17 00 77 79
florian.stoebe@cbre.com

A PROJECT OF



hillwood.com

IN COOPERATION WITH



logproject.eu